

Revision History			
REV	DESCRIPTION (ECO)	DATE	APPROVED
L	SHOW OLD MOLD / NEW MOLD VIEWS ECN 5101	2/8/12	AK
M	ADD SUB MAT. FOR "GW" SUFFIX ECO 5510	2/06/13	AK

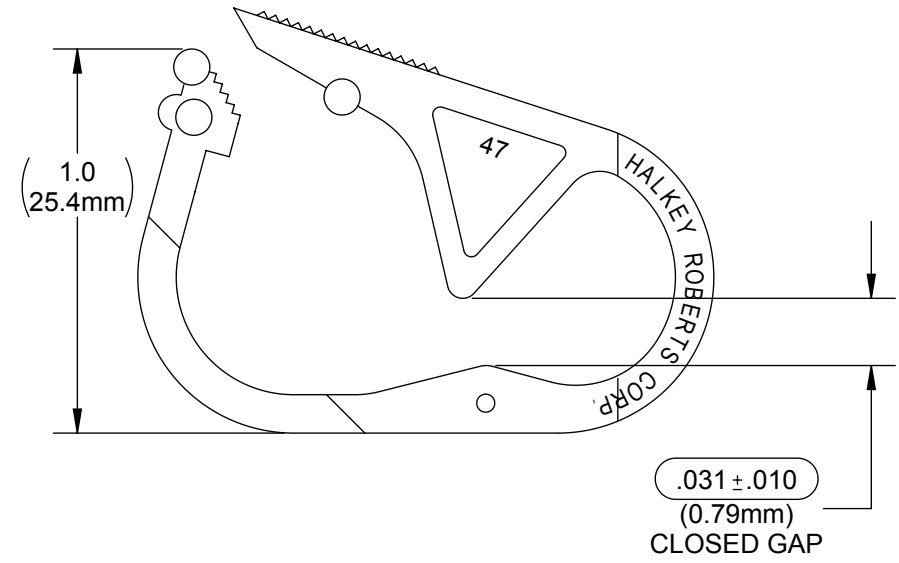
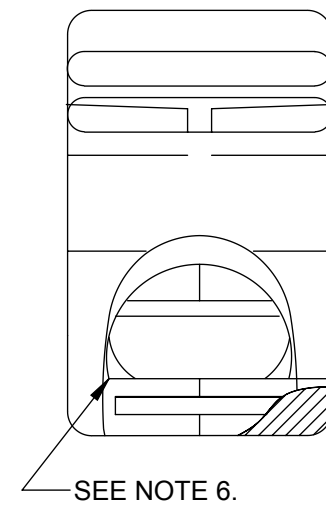
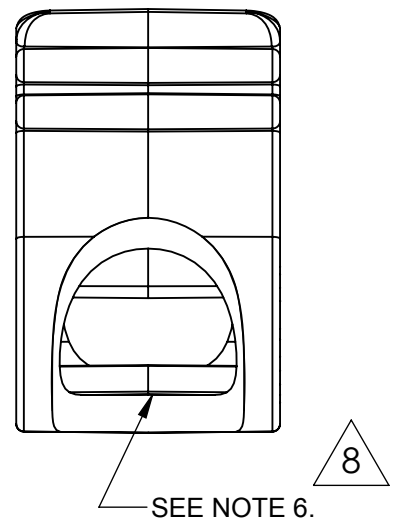
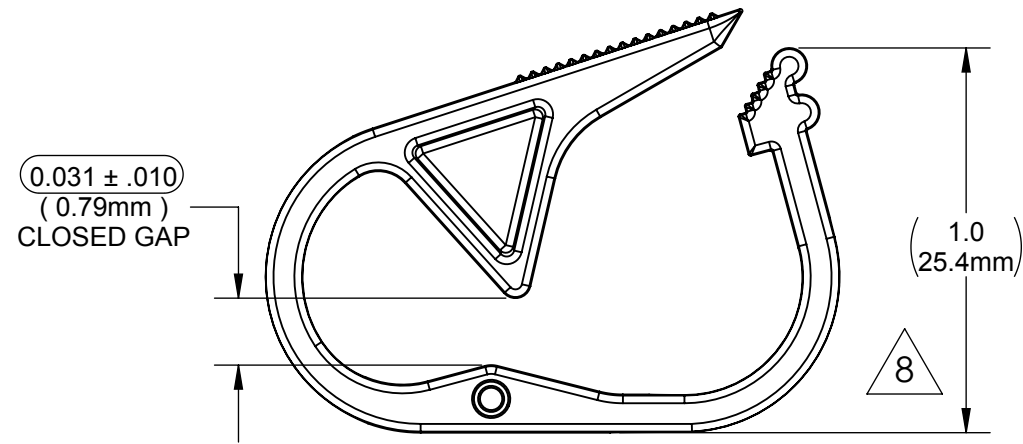
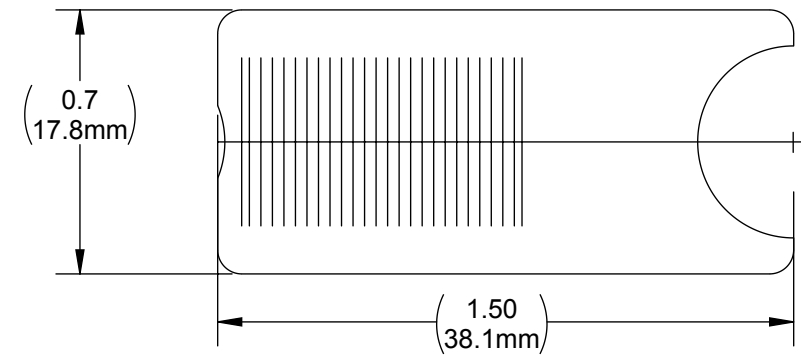
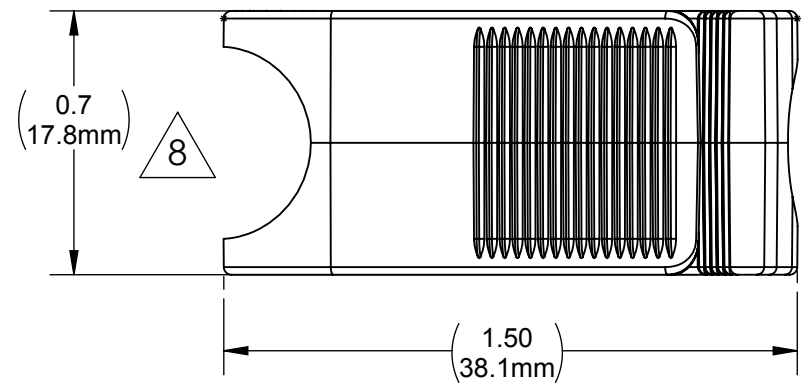

- NOTES:
- SUFFIX INDICATES MATERIAL & COLOR:
 NO SUFFIX WHITE POLYPROPYLENE
 B - BLUE " "
 R - RED " "
 Y - YELLOW " "
 GW - WHITE POLYPROPYLENE GAMMA STABLE
 VX - WHITE VALOX

- CRITICAL DIMENSIONS ARE CIRCLED AND SUBJECT TO INSPECTION.
- DIMENSIONS IN PARENTHESES ARE FOR REFERENCE ONLY.
- ALL DIMENSIONS ARE IN INCHES WITH NOMINAL IN MILLIMETERS BELOW.
- MISMATCH SHOULD BE NO MORE THAN .005 MAX.
- MAX TUBING DIA. (0.50").

7. HR TUBING CLAMPS ARE SINGLE PATIENT USE MEDICAL COMPONENTS INTENDED TO BE INCLUDED AS PART OF THE FINISHED DEVICE, I.E. IV ADMINISTRATION SETS. HR TUBING CLAMPS ARE MANUFACTURED TO HR SPECIFICATIONS, SOLD BULK, NON-STERILE TO OEMS. BECAUSE THE CONFIGURATIONS OF IV TUBING VARY DRAMATICALLY, HR CANNOT MAKE ANY PARTICULAR CLAIMS. CUSTOMERS MUST VALIDATE CLAMPS FOR THEIR INTENDED USE, ENSURING THAT THE CLAMPS EFFECTIVELY OCCLUDE THE INHERENT VARIATION OF THE PARTICULAR TUBING EMPLOYED BY THE CUSTOMER AGAINST THE CLOSED GAP RANGE PROVIDED ON HR'S SPECIFICATIONS. OEM MANUFACTURING PROCESSES (SUCH AS ASSEMBLY PROCESSES, PACKAGING AND STERILIZATION) CAN SIGNIFICANTLY ALTER THE CLAMPS' FUNCTIONALITY; THEREFORE, HR CANNOT GUARANTEE THE PERFORMANCE OF THE FINAL CONFIGURATION.

8. ALTERNATE VIEWS ARE SHOWN OF NEW MOLD, RADIUS CONFIGURATION.

QUALITY CRITERIA	
O.D. FLASH	0.015 MAX. (0.4MM)
GATE VESTIGE	0.01 MAX. (0.3MM)
EMBEDDED PARTICLES, BUBBLES, SPOTS, STAINS:	0.3mm ² MAX. NO MORE THAN 5 PER PART.

MOLDED PARTS:
GATES, PARTING LINES, AND FLASH PER QUALITY CRITERIA

PROPRIETARY AND CONFIDENTIAL
THE INFORMATION CONTAINED IN THIS DRAWING IS THE SOLE PROPERTY OF HALKEY-ROBERTS CORPORATION, ST. PETERSBURG, FL. ANY REPRODUCTION IN PART OR AS A WHOLE WITHOUT THE WRITTEN PERMISSION OF HALKEY-ROBERTS CORPORATION IS PROHIBITED.

DRAWN BY	dcoughlin	DATE	2/13/2013
APPROVED BY	-	DATE	-
MATERIAL	SEE NOTES		
FINISH			
UNLESS OTHERWISE SPECIFIED:	DIMENSIONS ARE IN INCHES TOLERANCES: ANGULAR: ±1° TWO PLACE DECIMAL ±.01 THREE PLACE DECIMAL ±.005		

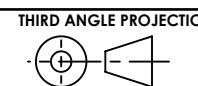

Halkey-Roberts

TUBING - CLAMP

DRAWING NO. C340TCOP2X REV **M**

SCALE: 2:1 DO NOT SCALE DRAWING SHEET 1 OF 2