

# SPRING CLIP WITH EYE

316 STAINLESS STEEL



Import



Wire Formed

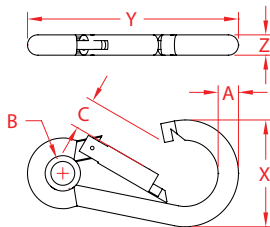

ITEM	A (size)	B	C	X (height)	Y (length)	Z (width)	WLL (lb)	WT (lb)	PACKAGING TYPE	EACH (qty)	INNER (qty)	CARTON (qty)	UPC
22962	3/16"	0.25"	0.25"	1.03"	2.00"	0.19"	120	0.04	POLYBAG	1	10	800	791506030997
22963	1/4"	0.30"	0.27"	1.16"	2.38"	0.23"	150	0.06	POLYBAG	1	10	500	791506031000
22964	9/32"	0.32"	0.34"	1.31"	2.75"	0.26"	200	0.09	POLYBAG	1	10	250	791506031017
22965	5/16"	0.40"	0.38"	1.57"	3.13"	0.30"	280	0.14	POLYBAG	1	10	200	791506031024
22966	3/8"	0.50"	0.54"	1.95"	3.88"	0.38"	400	0.27	POLYBAG	1	10	100	791506031031
22967	7/16"	0.60"	0.65"	2.35"	4.75"	0.42"	500	0.41	POLYBAG	1	1	60	791506031048
22968	15/32"	0.80"	0.80"	2.62"	5.50"	0.46"	750	0.57	POLYBAG	1	1	50	791506031055
22969	1/2"	0.87"	0.95"	2.92"	6.15"	0.50"	900	0.76	POLYBAG	1	1	40	791506031062

**NOTE:**

**EACH CLIP IS STAMPED WITH "316" AND WLL (LB). COMMERCIAL GRADE.  
ALL DIMENSIONS ARE NOMINAL (+/- 3%) AND ARE SUBJECT TO CHANGE WITHOUT NOTICE.**