

Catalog Options:
Cover #11037

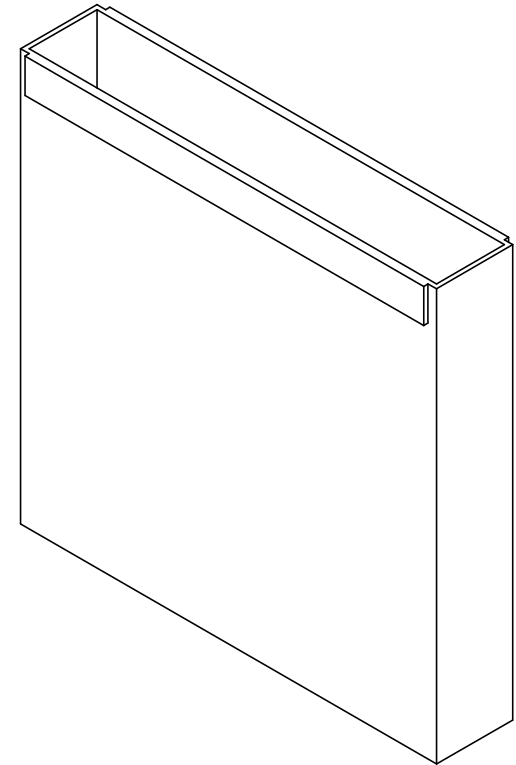

Polyethylene Tank
#11208

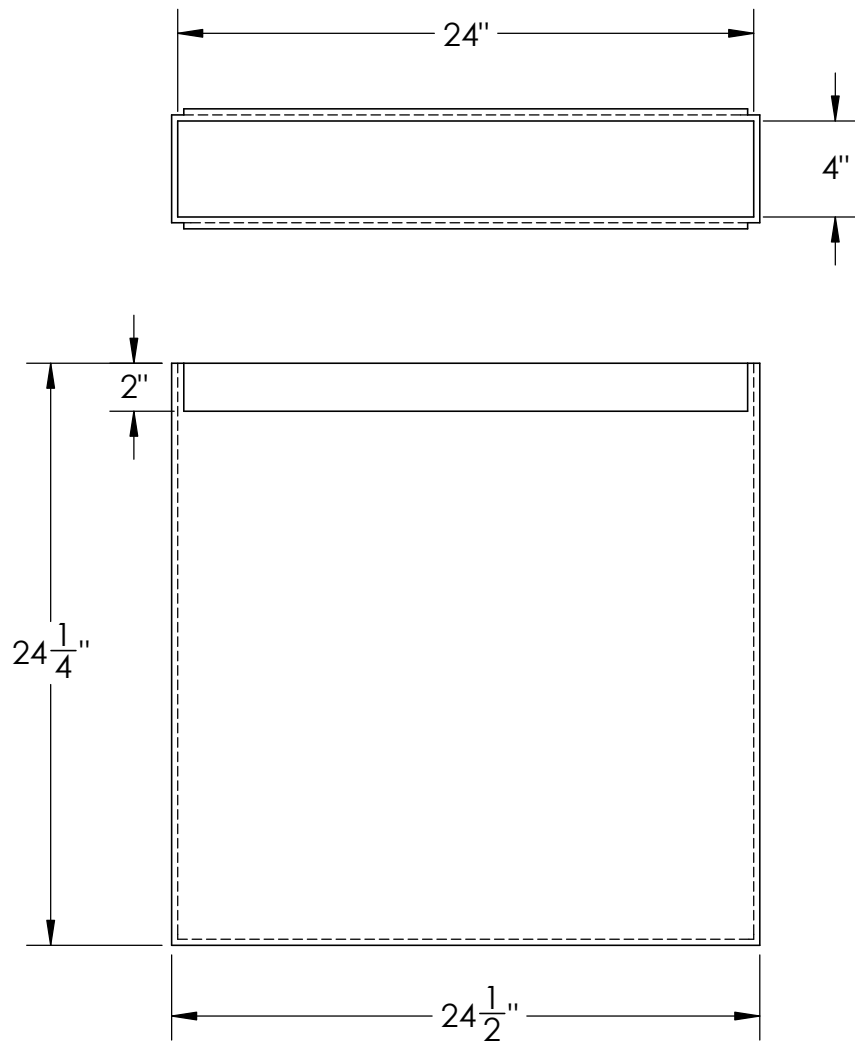

1390 Neubrecht Road
Lima, Ohio 45801

STOCK NO.

11208

REV

A

DO NOT SCALE DRAWING

WEIGHT: 14.5 lbs.

PROPRIETARY AND CONFIDENTIAL

THE INFORMATION CONTAINED IN THIS
DRAWING IS THE SOLE PROPERTY OF
TAMCO. ANY REPRODUCTION IN PART
OR AS A WHOLE WITHOUT THE WRITTEN
PERMISSION OF TAMCO IS PROHIBITED.

MAX. OPERATING TEMP. 200°F
SEE CHEMICAL RESISTANCE
CHART FOR COMPATABILITY

DIMENSIONS ARE IN INCHES
TOLERANCE: $\pm 1/4"$

MATERIAL

Welded PE

CAPACITY

10 US gal.

GRADUATIONS

NO

NOMINAL WALL THICKNESS

1/4"

DRAWN

NAME

JMP

DATE

6/24/19

APPROVED

COMMENTS:

Welded
Construction