

SECTION A-A

- NOTES:
- 1. CAP THREAD IS MODIFIED BUTTRESS THREAD 2.25" - 5 TPI
 - 2. SEE DWG S-10307 FOR MATING THREAD SPECIFICATIONS.
 - 3. TESTING AND VERIFICATION THAT THIS PRODUCT IS APPROPRIATE FOR THE APPLICATION FOR WHICH IT IS INTENDED IS THE SOLE RESPONSIBILITY OF THE PURCHASING PARTY.

REVISIONS					
REV	ECR	DESCRIPTION	DATE	BY	APR
A	NPN	RELEASED FOR PRODUCTION	03-22-21	CRW	PAM

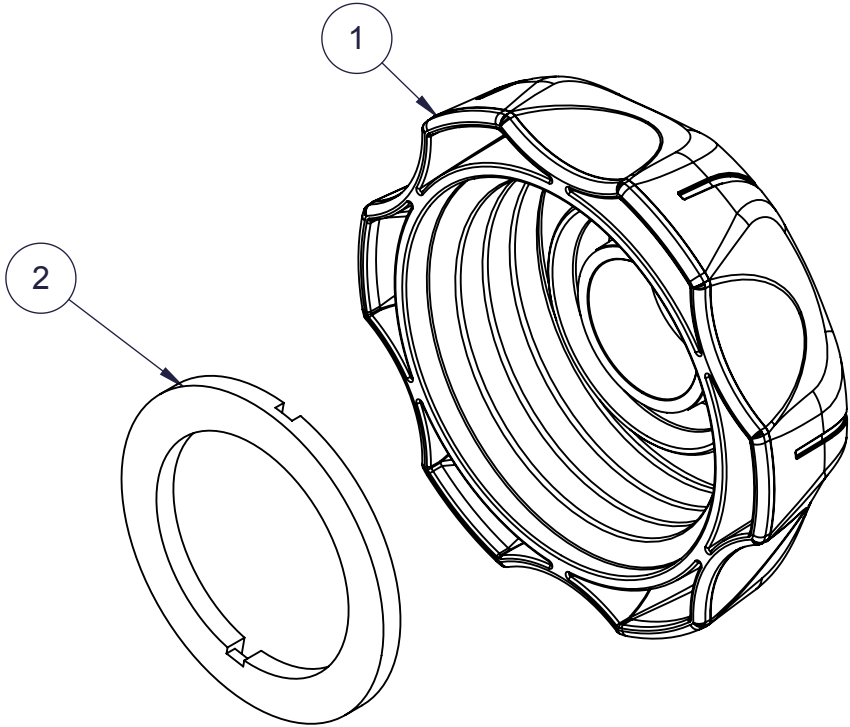

2	468833A	468833A	GASKET, FLUIDS 2.25" THREAD VENT		1
1	6825	S-10851	PDM-00100 2.25 Cap 6 lobe thd. vented		1
ITEM	FPN	DWG #	DESCRIPTION		QTY
PROPRIETARY AND CONFIDENTIAL THE INFORMATION CONTAINED IN THIS DRAWING IS THE SOLE PROPERTY OF FLAMBEAU, INC. ANY REPRODUCTION IN PART OR AS A WHOLE WITHOUT THE WRITTEN PERMISSION OF FLAMBEAU, INC. IS PROHIBITED.		SHT	<div><div>F</div>FLAMBEAU, INC.</div>		
		1			
		OF	2.25" THREAD VENT CAP, PLAIN - BLACK		
		1			
DIMENSIONS ARE IN INCHES. THE FOLLOWING TOLERANCES APPLY UNLESS OTHERWISE SPECIFIED ANGULAR: ±3° TWO PLACE x.xx ±.01" THREE PLACE x.xxx ±.005"		Description:			
		Customer: FLAMBEAU FLUID SYSTEMS		Dwg No: 080294	