

| ITEM NO. | FPN | Drawing # | Description | QTY |
|----------|---------|-----------|---|-----|
| 1 | 065401 | 4315-3 | Four Quart Tank, Integral w/Grommet | 1 |
| 2 | 063366 | 063366 | 2.25" Top-Vent Fluids Cap w/Tether, WW, HDPE, Blk | 1 |
| 3 | 066011A | 066011 | 12 Volt Pump | 1 |

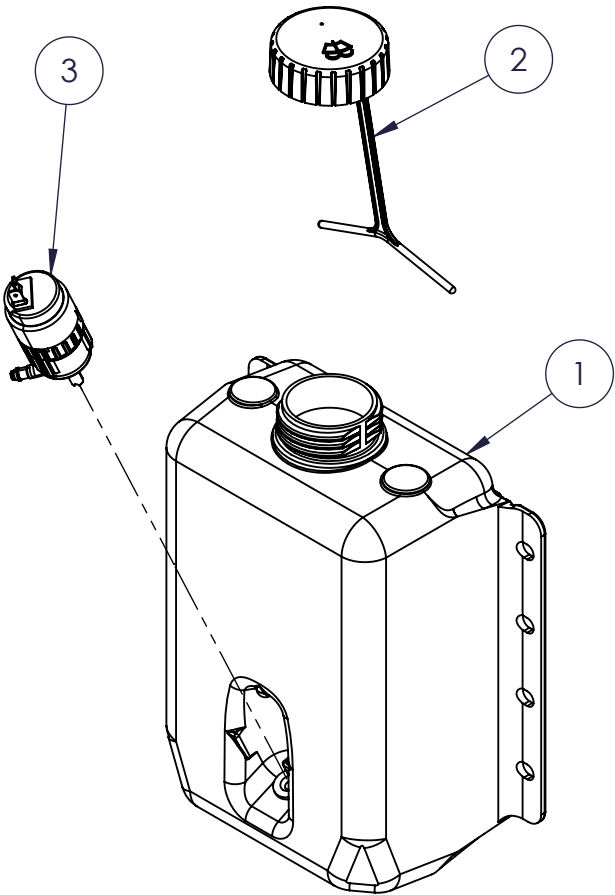

| | | | | | |
|-----------|-----|--------------------------|---------|-----|-----|
| B | NPN | Redrawn, Pump was 066011 | 5-18-12 | RDL | PSB |
| REV | ECR | DESCRIPTION | DATE | BY | APR |
| REVISIONS | | | | | |

| | | | |
|--|---|------------|-----------------------------|
| SHT 1 OF 1 | FLAMBEAU, INC. 911 LYNN AVENUE BARABOO, WI 53913 PH.(608)356-5551 | | |
| | Scale: 1:3 | BFI No: NA | Drawn By: ANA Date: 8-19-11 |
| | Mold No: NA | Mat'l: NA | FPN: 065400 |
| | Approvals | | |
| Eng: | | MFG: | QLTY: |
| Description: 4 Quart 12 Volt Washer Assembly | | | |
| Customer: Flambeau Fluid Systems | | | Dwg No: 065400 |