

DETAIL A

ALL FILLETS AND  
ROUNDS R $\frac{1}{8}$ "

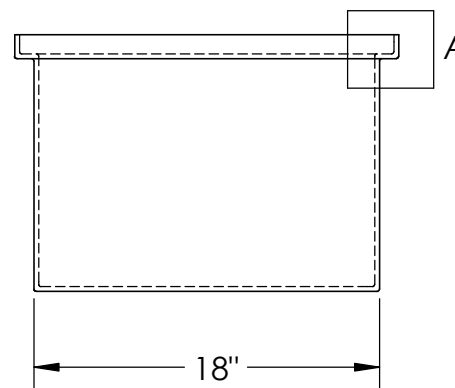

Catalog options:  
Cover #14565

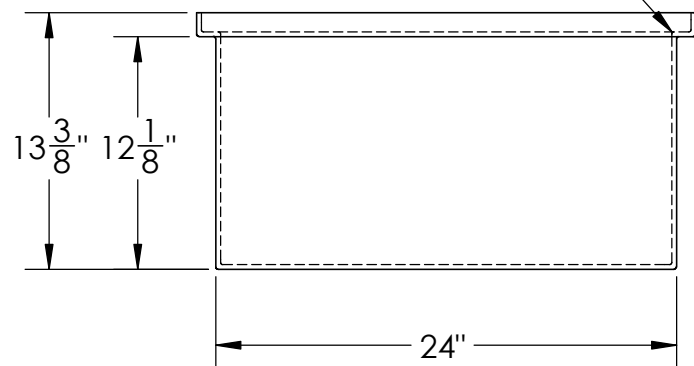
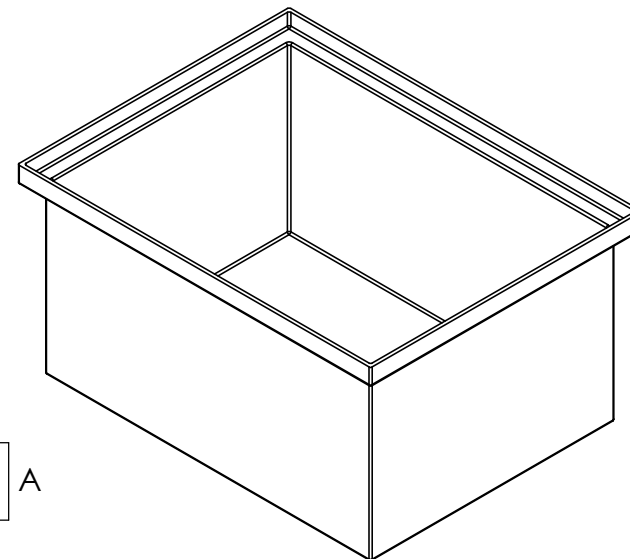

Heavy Duty Polyethylene  
Tank w/ Internal Flange #14833



1390 Neubrecht Road  
Lima, Ohio 45801

STOCK NO.

14833

REV

A

DO NOT SCALE DRAWING

WEIGHT: 12 lbs.

**PROPRIETARY AND CONFIDENTIAL**

THE INFORMATION CONTAINED IN THIS  
DRAWING IS THE SOLE PROPERTY OF  
TAMCO. ANY REPRODUCTION IN PART  
OR AS A WHOLE WITHOUT THE WRITTEN  
PERMISSION OF TAMCO IS PROHIBITED.

MAX. OPERATING TEMP. 140°F  
INTERMITTENT SERVICE TO 160°F  
SEE CHEMICAL RESISTANCE  
CHART FOR COMPATABILITY

DIMENSIONS ARE IN INCHES  
TOLERANCE:  $\pm 1/4$ "

MATERIAL  
LLDPE - FDA resin

CAPACITY  
22 US gal.

GRADUATIONS  
NO

NOMINAL WALL THICKNESS  
1/4"

	NAME	DATE
DRAWN	JMP	11/19/18
APPROVED		

COMMENTS:

Black  
UV Stabilized