

Catalog options:
Cover # 15786

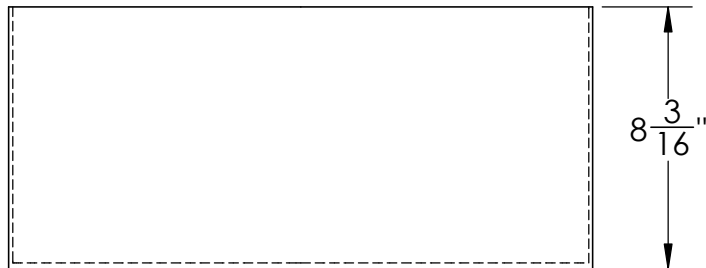

Polyethylene Round Tray
#15772

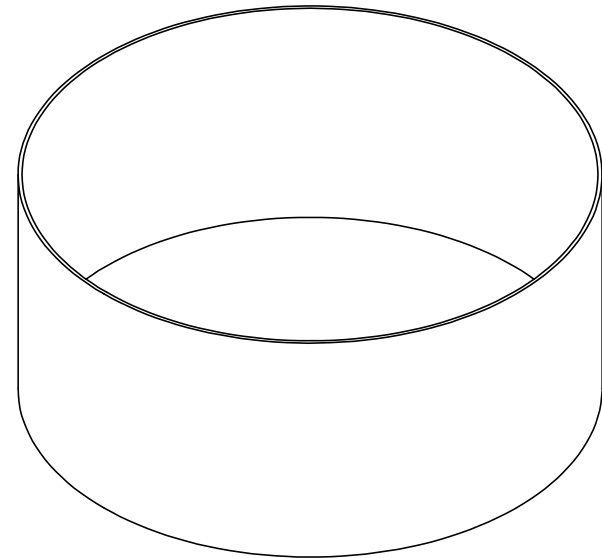

1390 Neubrecht Road
Lima, Ohio 45801

STOCK NO. **15772** REV **A**

DO NOT SCALE DRAWING

WEIGHT: 4 lbs.

DIMENSIONS ARE IN INCHES TOLERANCE: $\pm 1/4$ "		NAME	DATE
MATERIAL	WELDED PE	DRAWN	JMP 6/7/19
CAPACITY		APPROVED	
GRADUATIONS	8.5 Gal.	COMMENTS: Other tray sizes, special partitions, flanges, outlets, etc. are available	
NOMINAL WALL THICKNESS	N/A		
	3/16" bottom 1/8" sides		

PROPRIETARY AND CONFIDENTIAL
THE INFORMATION CONTAINED IN THIS DRAWING IS THE SOLE PROPERTY OF TAMCO. ANY REPRODUCTION IN PART OR AS A WHOLE WITHOUT THE WRITTEN PERMISSION OF TAMCO IS PROHIBITED.

MAX. OPERATING TEMP. 140°F
INTERMITTENT SERVICE TO 160°F
SEE CHEMICAL RESISTANCE
CHART FOR COMPATABILITY