

3/4" PP Bulkhead
Tank Fitting

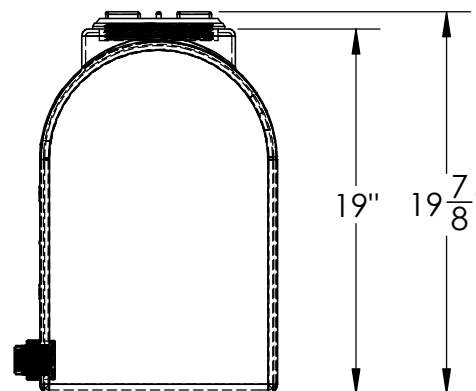

Black 15 Gal Loaf Tank

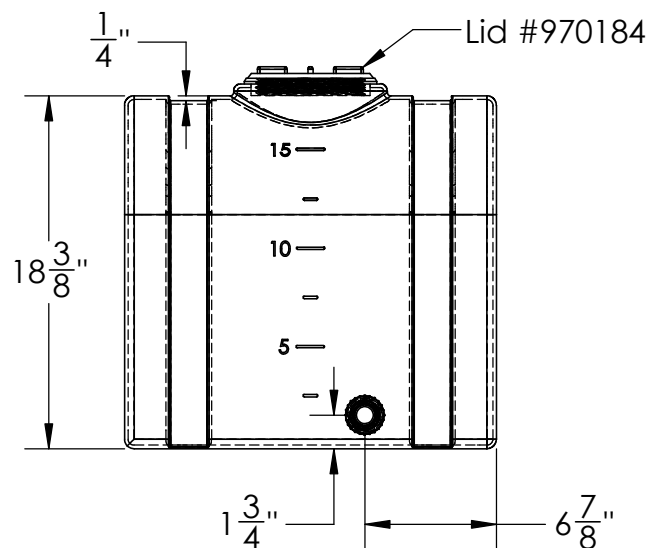
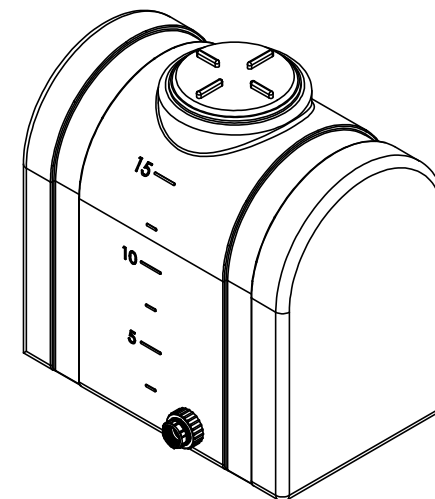

1390 Neubrecht Road
Lima, Ohio 45801

STOCK NO.

17874

REV

A

DO NOT SCALE DRAWING

WEIGHT: 10 lbs.

PROPRIETARY AND CONFIDENTIAL

THE INFORMATION CONTAINED IN THIS
DRAWING IS THE SOLE PROPERTY OF
TAMCO. ANY REPRODUCTION IN PART
OR AS A WHOLE WITHOUT THE WRITTEN
PERMISSION OF TAMCO IS PROHIBITED.

MAX. OPERATING TEMP. 140°F
INTERMITTENT SERVICE TO 160°F
SEE CHEMICAL RESISTANCE
CHART FOR COMPATIBILITY

DIMENSIONS ARE IN INCHES
TOLERANCE: $\pm 1/4"$

MATERIAL
LLDPE - FDA resin

CAPACITY
15 Gallon

GRADUATIONS
2.5 Gallon

NOMINAL WALL THICKNESS
3/16"

DRAWN

NAME

JMP

DATE

03/22/21

APPROVED

REVISIONS

COMMENTS:

UV Stabilized
Black