

$\phi 19 \frac{7}{8}$ "

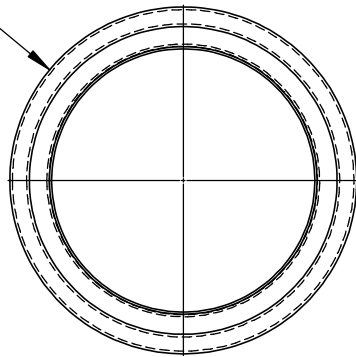

Catalog options:
Cover #3381, Tank Stand #5061-Includes agitator column

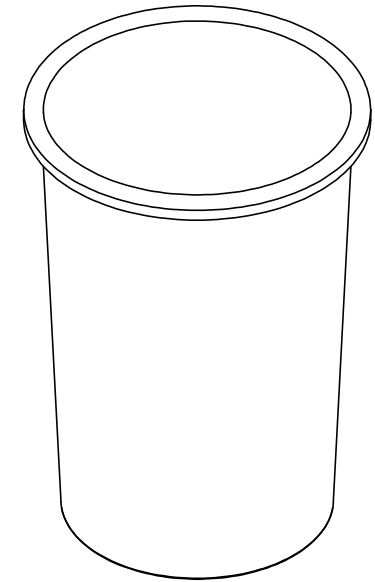
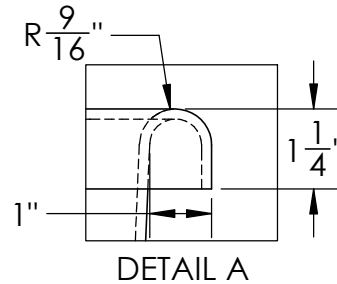
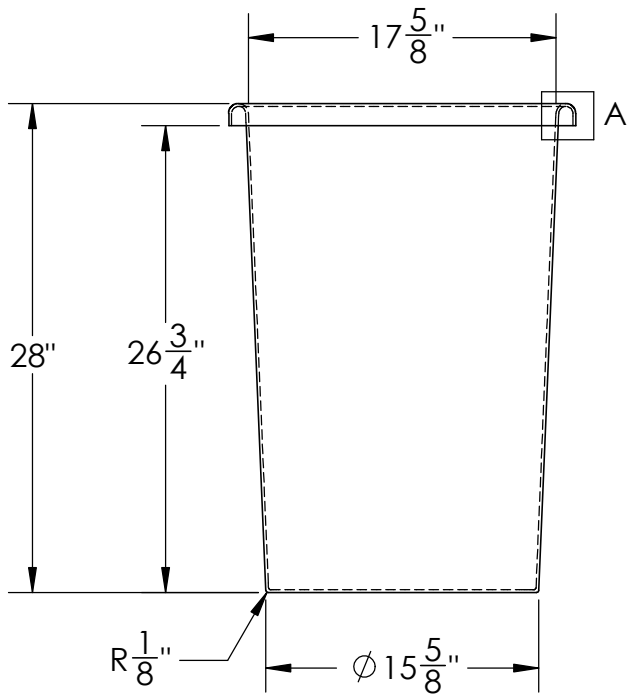

Tapered & Calibrated
Polyethylene Tank w/ Cuff
Type Flange #4890



1390 Neubrecht Road
Lima, Ohio 45801

STOCK NO.

4890

REV

A

DO NOT SCALE DRAWING

WEIGHT: 10 lbs.

DIMENSIONS ARE IN INCHES TOLERANCE: $\pm 1/4$ "		NAME	DATE
MATERIAL	LLDPE - FDA resin	DRAWN	JMP 11/27/18
CAPACITY	25 US gal.	APPROVED	
GRADUATIONS	2-1/2 gal.	COMMENTS: Black UV Stabilized	
NOMINAL WALL THICKNESS	5/32"		

PROPRIETARY AND CONFIDENTIAL

THE INFORMATION CONTAINED IN THIS DRAWING IS THE SOLE PROPERTY OF TAMCO. ANY REPRODUCTION IN PART OR AS A WHOLE WITHOUT THE WRITTEN PERMISSION OF TAMCO IS PROHIBITED.

MAX. OPERATING TEMP. 140°F
INTERMITTENT SERVICE TO 160°F
SEE CHEMICAL RESISTANCE
CHART FOR COMPATABILITY