

DETAIL A

Catalog options:
Cover #6378

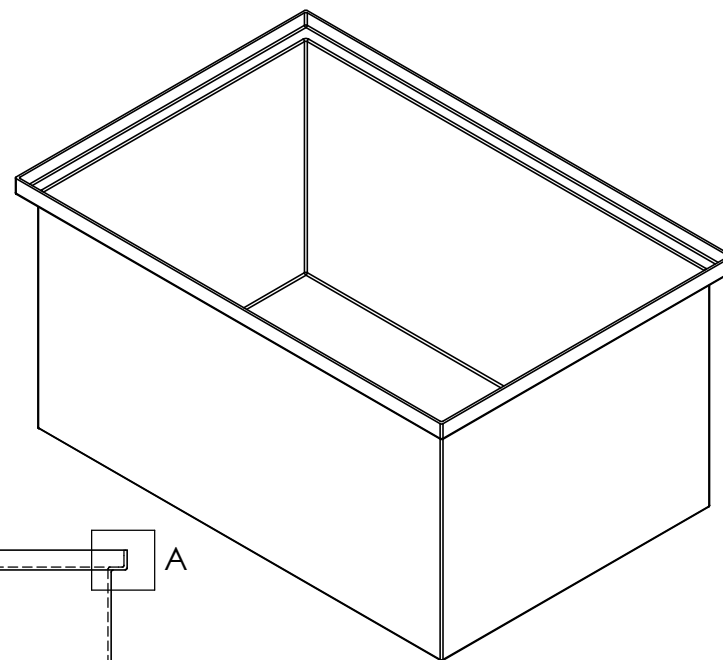

ALL FILLETS AND
ROUNDS $R\frac{1}{8}"$

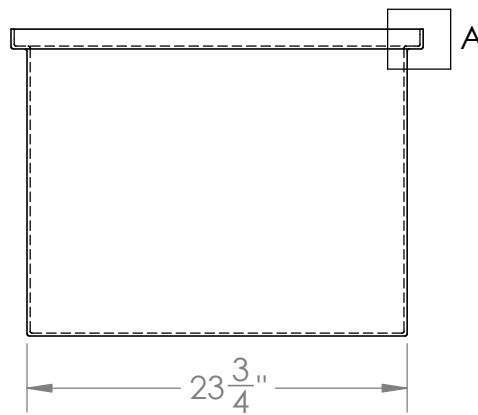
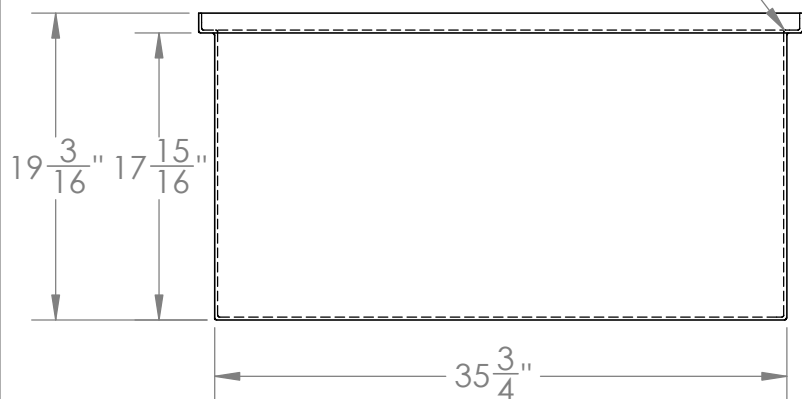

Heavy Duty Polyethylene
Tank w/ Internal Flange #6329



1390 Neubrecht Road
Lima, Ohio 45801

STOCK NO.

6329

REV

A

DO NOT SCALE DRAWING

WEIGHT: 30 lbs.

PROPRIETARY AND CONFIDENTIAL

THE INFORMATION CONTAINED IN THIS
DRAWING IS THE SOLE PROPERTY OF
TAMCO. ANY REPRODUCTION IN PART
OR AS A WHOLE WITHOUT THE WRITTEN
PERMISSION OF TAMCO IS PROHIBITED.

MAX. OPERATING TEMP. 140°F
INTERMITTENT SERVICE TO 160°F
SEE CHEMICAL RESISTANCE
CHART FOR COMPATABILITY

DIMENSIONS ARE IN INCHES
TOLERANCE: $\pm 1/4"$

MATERIAL
LLDPE - FDA resin

CAPACITY
67 US gal.

GRADUATIONS
NO

NOMINAL WALL THICKNESS
3/16"

DRAWN

NAME

DATE

CDH

06/13/16

APPROVED

BAT

07/14/16

COMMENTS:

Translucent
UV Stabilized