

PROPRIETARY DATA

PROPERTY OF ACE ROTO-MOLD MFG., INC. INFORMATION FURNISHED HEREIN IS THE PROPERTY OF ACE ROTO-MOLD MFG., INC. AND SHALL NOT BE USED, DISCLOSED TO OTHERS, OR COPIED WITHOUT THE EXPRESSED WRITTEN CONSENT OF ACE ROTO-MOLD MFG., INC. ALL RIGHTS RESERVED.

IN40-ST

G

KEY	PART NUMBER	MATERIAL	DESCRIPTION	QTY.
1	IN40-ST-1	BQ2500X20000	1/4 X 2 FLAT	4 @ 19.9375 IN <79.75 IN>
2	IN40-ST-2	BQ2500X20000	1/4 X 2 FLAT	4 @ 22 IN <88 IN>
3	IN40-ST-3	P10000	TUBING, 1" SIZE PIPE	4 @ 35.875 IN<143.5 IN>
4	IN40-ST-4	R03125	5/16" ROD	29 IN
5	IN40-ST-5	BQ2500X10000	1/4 X 1 FLAT	4 @ 9.50 IN <38 IN>
6	IN40-ST-6	BQ2500X10000	1/4 X 1 FLAT	4 @ 16.50 IN <66 IN>
7	12583	62202	PIPE PLUG, 1 INCH	4

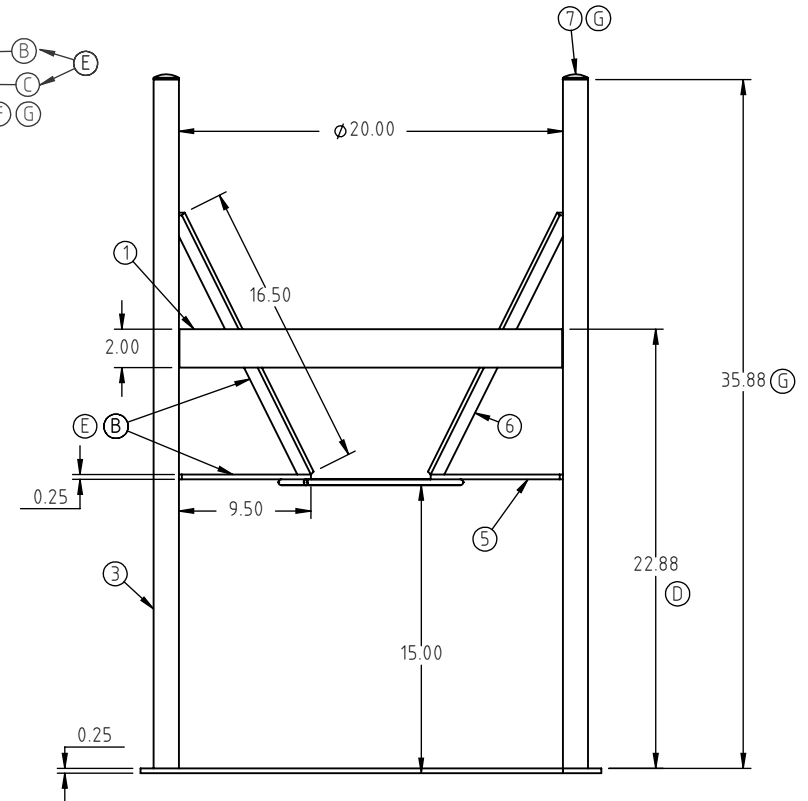
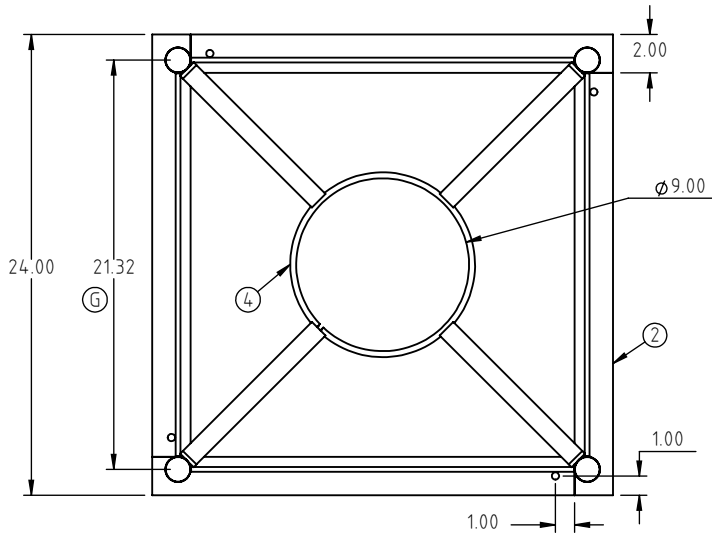

G	DIMENSIONS AND LEG PLUGS UPDATED	ADH 10/14/08	1729
F	CORRECTED PART NUMBER	ADH 10/31/07	1506
E	LENGTH WAS 9.75 AND 17.00	ADH 7/25/07	1395
D	WAS 24.25	DHJ 6/21/07	
C	LENGHT/BOM CHANGE	ADH 6/18/07	
B	LENGTH WAS 9.50 AND 16.75	ADH 6/13/07	1354
A	TOLERANCE WAS 1% @ 68° F	GWC 3/15/07	
REV	DESCRIPTION	BY / DATE	CCN

DRAWN / DATE	MATERIAL
ADH 7/19/07	
APPRD. / DATE	
REH 10/5/07	

ALL DIMENSIONS ARE IN DECIMAL INCHES
TOLERANCES UNLESS OTHERWISE SPECIFIED

DECIMAL ± .125"
FRACTION ± 1/4"
ANGLE ± 1°

THIRD ANGLE PROJECTION
ANSI 14.5M

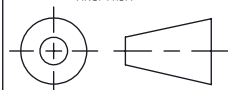

NOTES:



Den Hartog
INDUSTRIES, INC.

Ace Roto-Mold Injection Molding Blow Molding Sowjoy

4010 HOSPERS DRIVE S. BOX 425, HOSPERS, IOWA 51238-0421

DESCRIPTION 40 GALLON INDUCTOR STAND FOR UPS SHIPPING

SCALE N.S.

PART NO. IN40-ST