

Catalog Options:  
Cover #9102  
Fittings available up to 1"

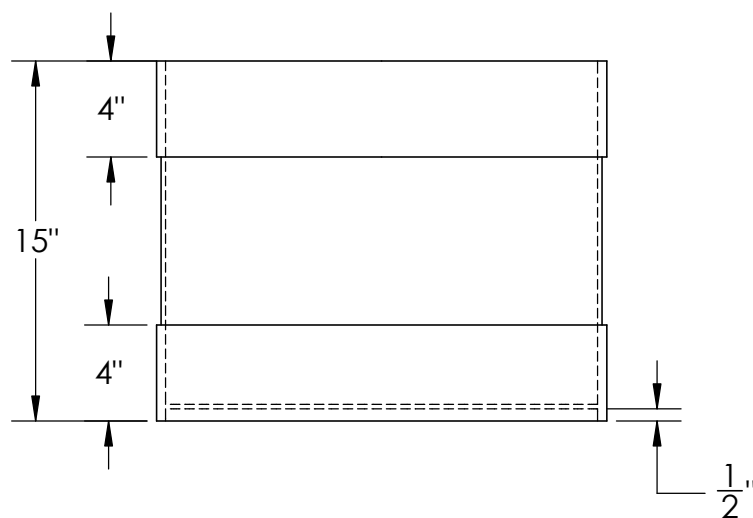
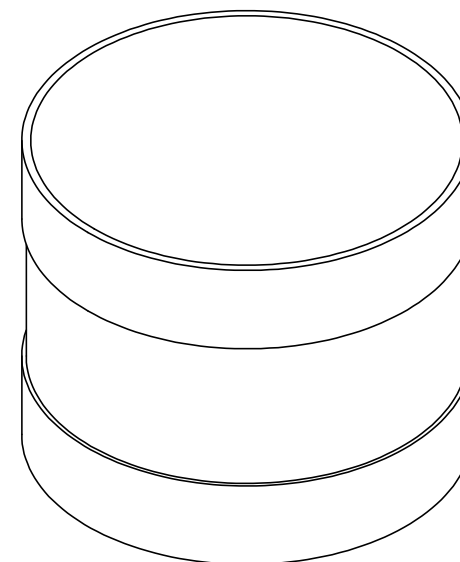

DIMENSIONS ARE IN INCHES TOLERANCE: $\pm 1/4"$		NAME	DATE
MATERIAL POLYPROPYLENE	CAPACITY 15 US gal.	DRAWN CDH	07/06/16
	GRADUATIONS NO	APPROVED BAT	07/14/16
NOMINAL WALL THICKNESS 3/16"		COMMENTS:  Welded Construction	

**PROPRIETARY AND CONFIDENTIAL**  
  
THE INFORMATION CONTAINED IN THIS  
DRAWING IS THE SOLE PROPERTY OF  
TAMCO. ANY REPRODUCTION IN PART  
OR AS A WHOLE WITHOUT THE WRITTEN  
PERMISSION OF TAMCO IS PROHIBITED.

MAX. OPERATING TEMP. 200°F  
SEE CHEMICAL RESISTANCE  
CHART FOR COMPATABILITY

Polypropylene Cylindrical  
Tank #9003



1390 Neubrecht Road  
Lima, Ohio 45801

STOCK NO.  9003	REV A
DO NOT SCALE DRAWING	WEIGHT: 14 lbs.