

Copyright. All information furnished within this document, electronic file or design correspondence is the property of Den Hartog Industries, Inc. and shall not be used, disclosed to others or copied without the expressed written consent of Den Hartog Industries, Inc.

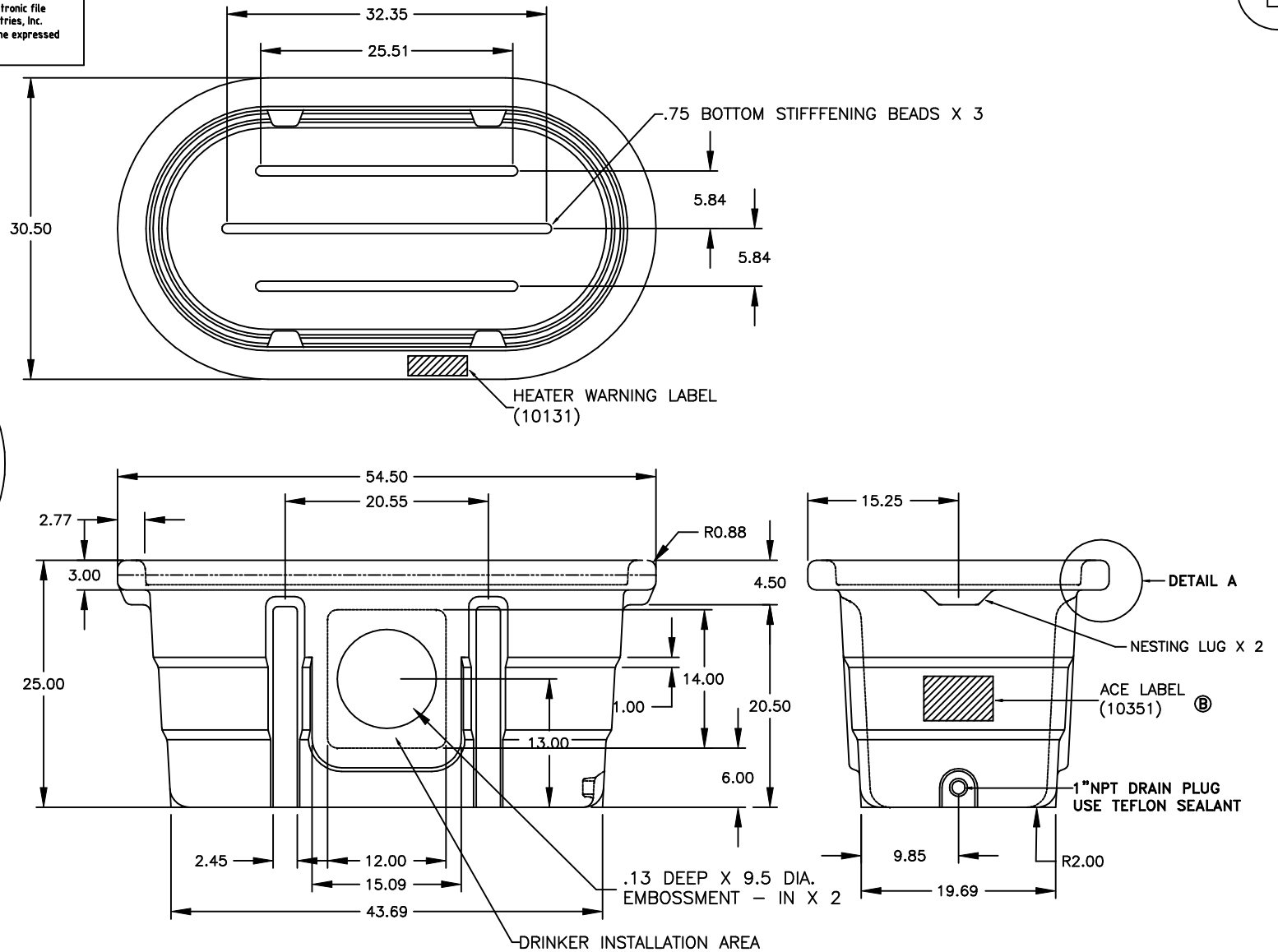

				DRAWN / DATE REH/5/22/98	MATERIAL 1.) POWDER, 5 MELT STD:10577
B	LABEL NUMBER ADDED, DRAWING TEMPLATE UPDATED	ADH 8/28/09	1916	APPRD. / DATE ADH 8/31/09	
A	PRINT UPDATE	9/17/98			
REV	DESCRIPTION	BY / DATE	CCN		
ALL DIMENSIONS ARE IN DECIMAL INCHES TOLERANCES UNLESS OTHERWISE SPECIFIED		THIRD ANGLE PROJECTION ANSI 14.5M		SHOT WEIGHT: 26 LBS	NOTES: 1. NOM. WALL = .150 2. STD. COLOR TO BE FOREST GREEN
POLYETHYLENE ±1% @ 68° F		METAL DECIMAL ± .125" FRACTION ± 1/4" ANGLE ± 1°		SHIPPING WEIGHT:	FINISH:



Den Hartog
INDUSTRIES, INC.

Ace Roto-Mold Injection Molding Blow Molding Sow-Joy
4010 HOSPERS DRIVE S. BOX 425, HOSPERS, IOWA 51238-0425

DESCRIPTION ACE / RE-224 POLY STOCK TANK	
SCALE N.S.	PART NO. ARM-10116