

SQUARE QUICK LINK

316 STAINLESS STEEL

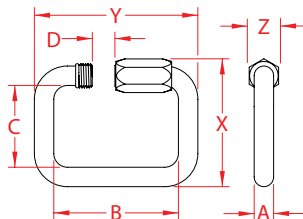

Import



Wire
Formed

ITEM	A (size)	B	C	D	X (height)	Y (length)	Z (width)	WLL (lb)	WT (lb)	PACKAGING TYPE	EACH (qty)	INNER (qty)	CARTON (qty)	UPC
23584	1/8"	1.08"	0.88"	0.19"	1.24"	1.36"	0.27"	330	0.02	POLYBAG	1	10	500	791506034902
23585	5/32"	1.23"	0.98"	0.22"	1.30"	1.55"	0.31"	440	0.03	POLYBAG	1	10	400	791506034919
23586	3/16"	1.47"	1.09"	0.25"	1.55"	1.89"	0.35"	710	0.06	POLYBAG	1	10	400	791506034926
23587	1/4"	1.69"	1.22"	0.30"	1.70"	2.15"	0.42"	990	0.09	POLYBAG	1	10	300	791506034933
23588	9/32"	1.95"	1.34"	0.34"	1.90"	2.52"	0.47"	1,300	0.13	POLYBAG	1	10	150	791506034940
23589	5/16"	2.17"	1.45"	0.41"	2.23"	2.81"	0.54"	1,600	0.20	POLYBAG	1	10	100	791506034957
23590	3/8"	2.36"	1.58"	0.44"	2.28"	3.13"	0.58"	2,100	0.27	POLYBAG	1	10	100	791506034964
23591	7/16"	2.70"	1.69"	0.47"	2.68"	3.50"	0.65"	2,700	0.38	POLYBAG	1	1	50	791506034971
23592	1/2"	3.08"	1.97"	0.59"	3.02"	4.03"	0.70"	3,800	0.58	POLYBAG	1	1	50	791506034988
23593	9/16"	3.50"	2.25"	0.67"	3.36"	4.70"	0.86"	5,400	0.96	POLYBAG	1	1	25	791506034995
23594	5/8"	4.06"	2.52"	0.75"	4.14"	5.30"	1.03"	6,900	1.50	POLYBAG	1	1	10	791506035008

NOTE:
ALL DIMENSIONS ARE NOMINAL (+/- 3%) AND ARE SUBJECT TO CHANGE WITHOUT NOTICE.