

SSPEX-ME SERIES STAINLESS STEEL PEX x MPT ELBOW

SPECIFICATION:

- For use with ASTM F2159 PEX cold & hot water distribution systems
- For use with SDR9 PEX tubing utilizing a crimp ring system
- Maximum Pressure Rating: 200 PSI
- Temperature Range: Up to 400°F (204°C)



CERTIFICATION:

- cUPC Listed
- NSF/ANSI 61 & 372 Certified
- Threads to ASME B1.20.1



MATERIAL LIST	
Name	Percent of Composition
304 Stainless Steel	
Iron (Fe)	64.0 - 72.0
Carbon (C)	0.08 max
Silicone (Si)	1.00 max
Manganese (Mn)	2.00 max
Phosphorus (P)	0.04 max
Sulfur (S)	0.04 max
Chromium (Cr)	18.0 - 21.0
Nickel (Ni)	8.0 - 11.0

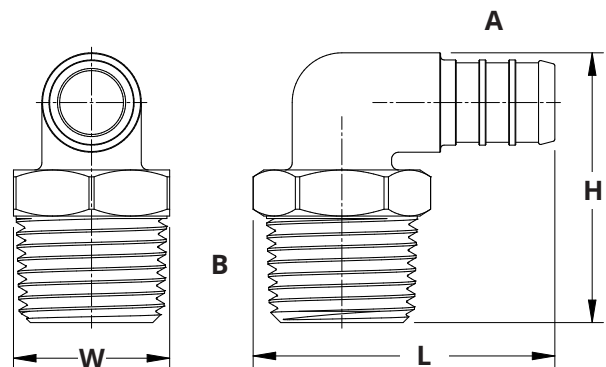

DIMENSIONS										
Part No.	Nominal Pipe Size		L		W		H		Weight	
	A	B	inches	mm	inches	mm	inches	mm	lbs	grams
SSPEX-ME05	1/2"	1/2"	1.60	40.64	0.85	21.59	1.50	38.10	0.11	49.90
SSPEX-ME07	3/4"	3/4"	1.85	46.99	1.05	26.67	1.65	41.91	0.18	81.65



25 Whaley Avenue, PO Box 310, Milverton, ON CANADA N0K 1M0
Tel: 800-561-3164

boshart.com ♦ blog.boshart.com