

SSPEX-P SERIES STAINLESS STEEL PEX PLUG



SPECIFICATION:

- For use with ASTM F2159 PEX cold & hot water distribution systems
- For use with SDR9 PEX tubing utilizing a crimp ring system
- Maximum Pressure Rating: 200 PSI
- Temperature Range: Up to 400°F (204°C)

CERTIFICATION:

- cUPC Listed
- NSF/ANSI 61 & 372 Certified



MATERIAL LIST	
Name	Percent of Composition
304 Stainless Steel	
Iron (Fe)	64.0 - 72.0
Carbon (C)	0.08 max
Silicon (Si)	1.00 max
Manganese (Mn)	2.00 max
Phosphorus (P)	0.04 max
Sulfur (S)	0.04 max
Chromium (Cr)	18.0 - 21.0
Nickel (Ni)	8.0 - 11.0

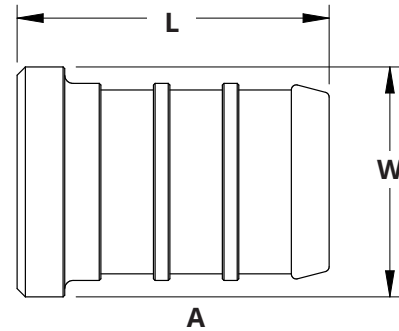

DIMENSIONS							
Part No.	Nominal Pipe Size	L		W		Weight	
	A	inches	mm	inches	mm	lbs	grams
SSPEX-P05	1/2"	0.75	19.05	0.45	11.43	0.04	18.14
SSPEX-P07	3/4"	0.75	19.05	0.65	16.51	0.08	36.29
SSPEX-P10	1"	0.95	24.13	0.85	21.59	0.15	68.04



25 Whaley Avenue, PO Box 310, Milverton, ON CANADA N0K 1M0
Tel: 800-561-3164

boshart.com ♦ blog.boshart.com