

DETAIL A

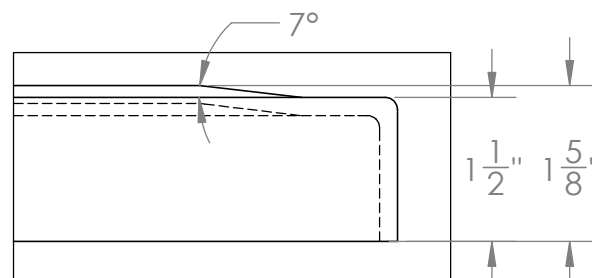

DETAIL B

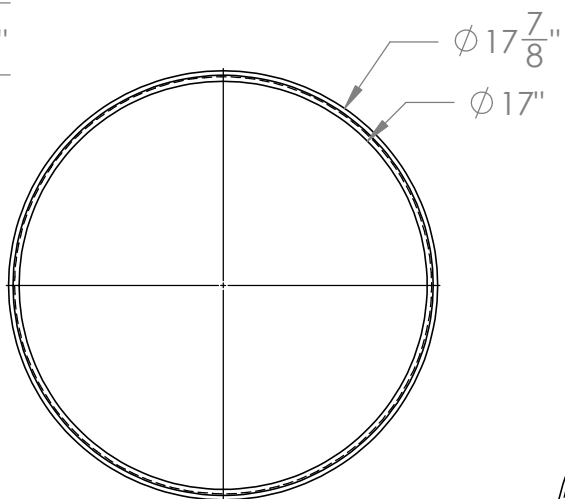
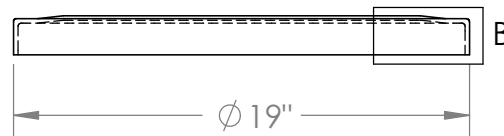
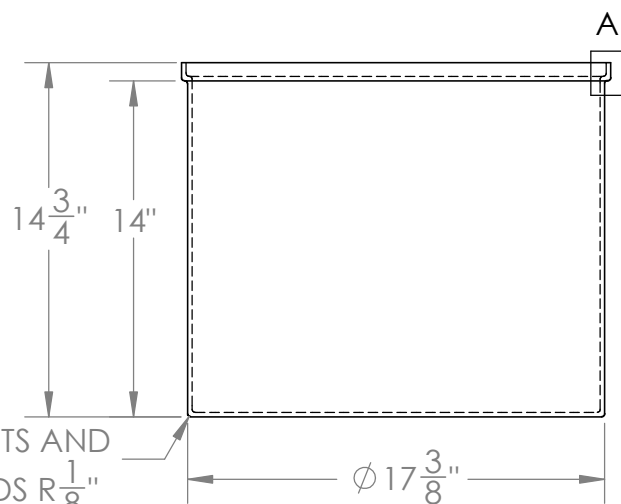
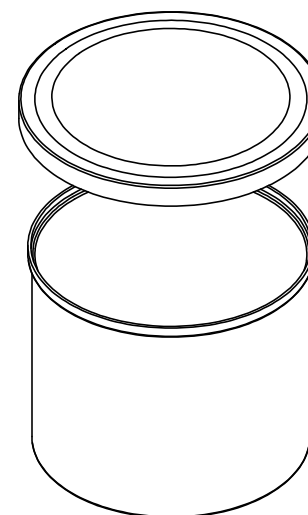
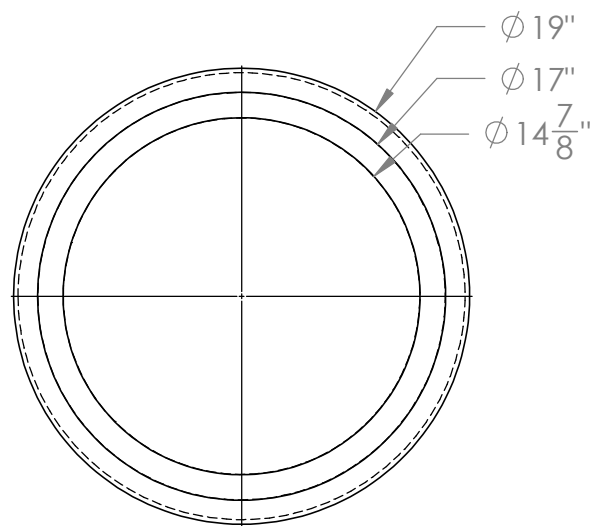

ALL FILETS AND  
ROUNDS  $R\frac{1}{8}$ "

**PROPRIETARY AND CONFIDENTIAL**

THE INFORMATION CONTAINED IN THIS DRAWING IS THE SOLE PROPERTY OF TAMCO. ANY REPRODUCTION IN PART OR AS A WHOLE WITHOUT THE WRITTEN PERMISSION OF TAMCO IS PROHIBITED.

MAX. OPERATING TEMP. 140°F  
INTERMITTENT SERVICE TO 160°F  
SEE CHEMICAL RESISTANCE  
CHART FOR COMPATIBILITY

DIMENSIONS ARE IN INCHES  
TOLERANCE:  $\pm 1/4$ "

MATERIAL  
LLDPE - FDA resin

CAPACITY  
14 US gal.

GRADUATIONS  
NO

NOMINAL WALL THICKNESS  
3/16"

	NAME	DATE
DRAWN	CDH	06/15/16
APPROVED	BAT	07/14/16

COMMENTS:

Black  
UV Stabilized

Black  
Molded Polyethylene  
Shallow Tank #14317



1390 Neubrecht Road  
Lima, Ohio 45801

STOCK NO.

14317

REV

A

DO NOT SCALE DRAWING

WEIGHT: 9 lbs.