

DETAIL A

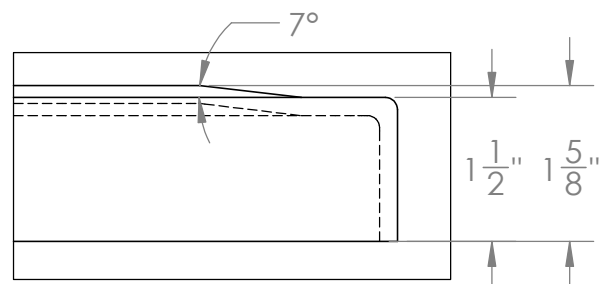

DETAIL B

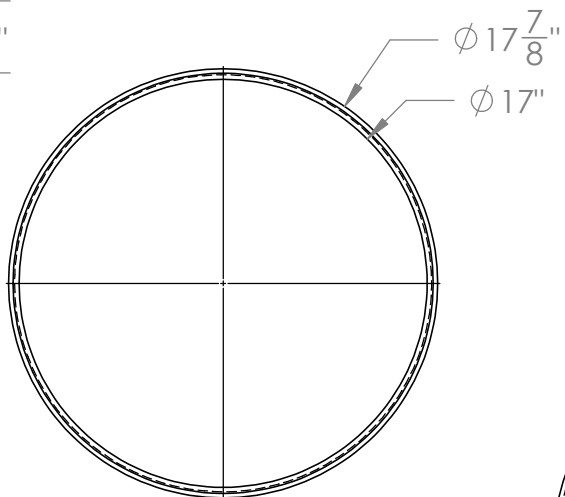
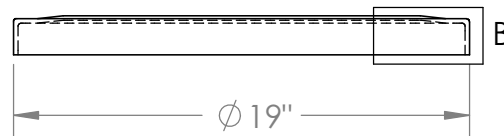
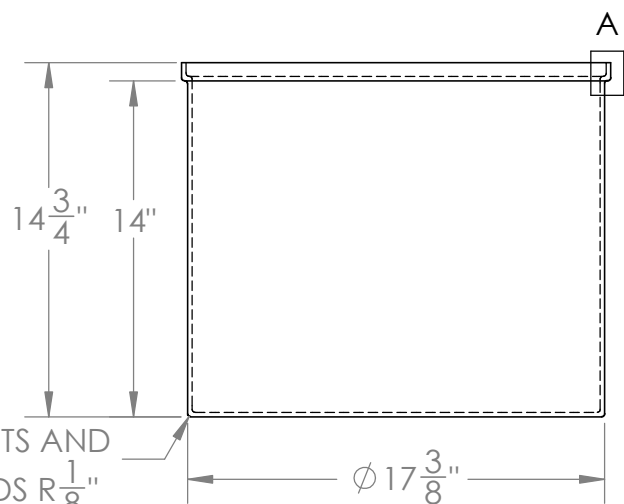
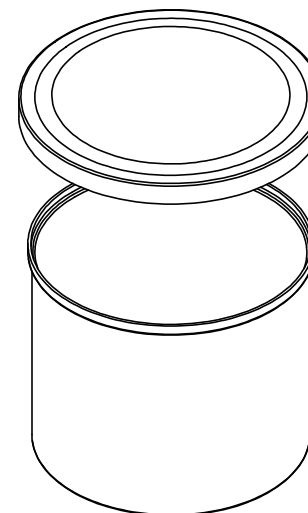
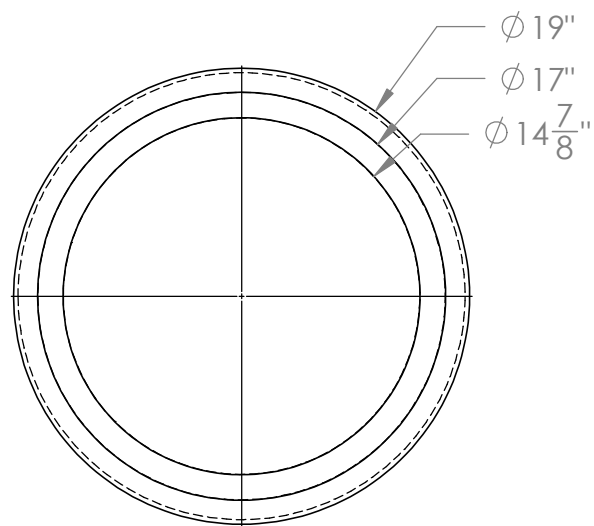

ALL FILETS AND
ROUNDS $R\frac{1}{8}$ "

PROPRIETARY AND CONFIDENTIAL

THE INFORMATION CONTAINED IN THIS DRAWING IS THE SOLE PROPERTY OF TAMCO. ANY REPRODUCTION IN PART OR AS A WHOLE WITHOUT THE WRITTEN PERMISSION OF TAMCO IS PROHIBITED.

MAX. OPERATING TEMP. 140°F
INTERMITTENT SERVICE TO 160°F
SEE CHEMICAL RESISTANCE
CHART FOR COMPATIBILITY

DIMENSIONS ARE IN INCHES
TOLERANCE: $\pm 1/4$ "

MATERIAL
LLDPE - FDA resin

CAPACITY
14 US gal.

GRADUATIONS
NO

NOMINAL WALL THICKNESS
3/16"

	NAME	DATE
DRAWN	CDH	06/15/16
APPROVED	BAT	07/14/16

COMMENTS:

Natural
UV Stabilized

Natural
Molded Polyethylene
Shallow Tank #14318



1390 Neubrecht Road
Lima, Ohio 45801

STOCK NO.

14318

REV

A

DO NOT SCALE DRAWING

WEIGHT: 9 lbs.